

2500 SERIES FIRE SMOKE CONTROL DAMPER

Declaration of Performance (DoP)

Complying with EU Regulation: 305/2011/EEC Construction Products Regulation



CONSTRUCTION PRODUCT	Fire Smoke Damper
INTENDED USE	Fire and smoke dampers for use where integrity and leakage are required, in both directions and in both horizontal and vertical orientations.
HARMONISED STANDARD	EN 15650
MANUFACTURER	Advanced Air (UK) Ltd Burrell Way, Thetford, Norfolk IP24 3QU Email projects@advancedair.co.uk Web www.advancedair.co.uk Tel 01842 765 657
SYSTEM OF ASSESSMENT AND VERIFICATION OF CONSTANCY OF PERFORMANCE	System 1
NOTIFIED BODY	The notified body 2831 – BRE carried out the initial inspection of the manufacturing plant and of the production control as well as the continuous surveillance and evaluation of the factory production control according to System 1 of the Construction Products Regulation.
CERTIFICATE OF CONSTANCY OF PERFORMANCE	2831-CPR-P0005 issued on 29 th August 2024

ESSENTIAL CHARACTERISTICS	REQUIREMENT CLAUSES IN EN 15650	PERFORMANCE LEVEL ACHIEVED	NOTES
Nominal activation conditions/sensitivity:	4.2.1.3		
– Sensing element load bearing capacity	4.2.1.2.2	Pass	
– Sensing element response temperature	4.2.1.2.3	Pass	
Response delay time	4.2.2.2	Pass	
Operation reliability – Cycling	4.3.1 (a)	Pass	50 cycles
FIRE RESISTANCE			
– Integrity	4.1.1 (a)	E	120 minutes
– Insulation	4.1.1 (b)	EI	No Performance Declared
– Smoke leakage	4.1.1 (c)	ES	120 minutes
– Mechanical stability (under E)	4.1.1 (a)	Pass	
– Maintenance of cross section (under E)	4.1.1 (a)	Pass	
DURABILITY			
-of response delay	4.2.1.2.2 & 4.2.1.2.3	Pass	
-of operation reliability	4.3.3.2	Pass	10,000 cycles

I hereby declare that the 2500 Fire Smoke Damper has been tested and fully complies with EN 15650 Ventilation for Buildings – Fire Dampers. The performance of the product identified above is in conformity with the set of declared performance/s. This declaration of performance is issued, in accordance with Regulation (EU) No 305/2011, under the sole responsibility of the manufacturer identified above.

On behalf of Advanced Air (UK) Ltd:

Andrew Sargent
Managing Director
4th November 2024 – Burrell Way



2500 SERIES FIRE SMOKE CONTROL DAMPER Declaration of Performance (DoP)

Complying with EU Regulation: 305/2011/EEC Construction Products Regulation



HEVAC – 2 HOUR WALL AND FLOOR

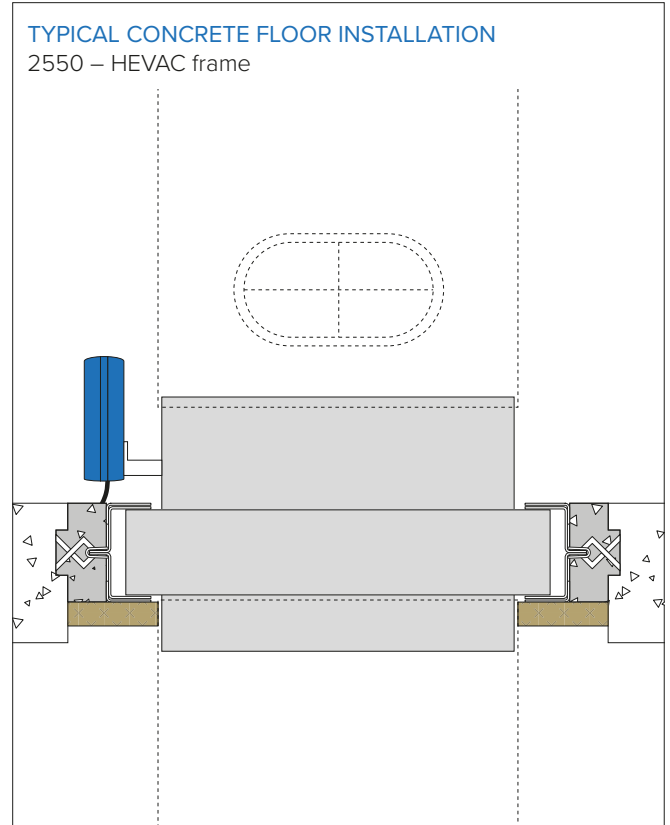
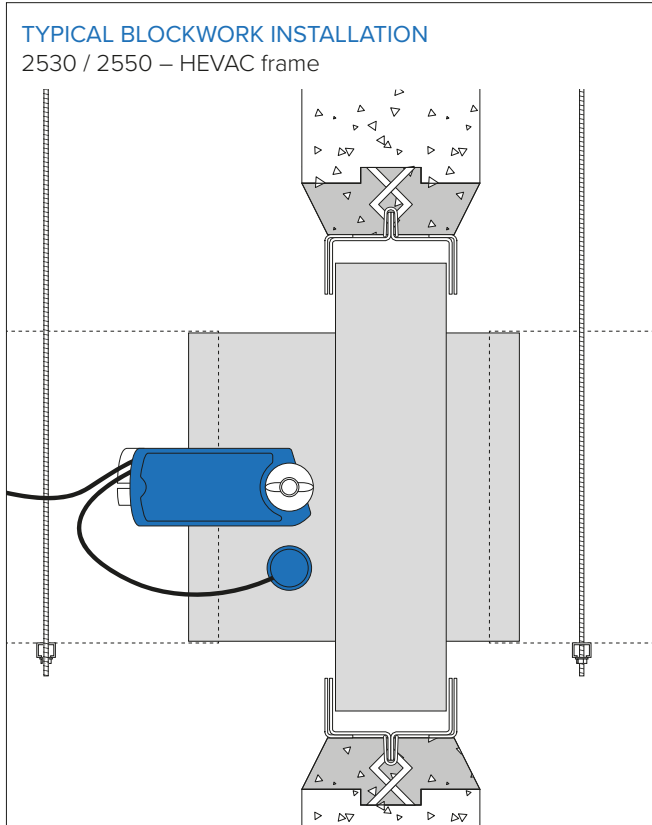

2530 / 2550 IN 2 HOUR WALL – RIGID CONSTRUCTION WITH HEVAC FRAME					
Size	Installation method	Supporting construction	Report no.	Date	Performance classification
Up to 1,000 x 1,000mm Single section	HEVAC	Rigid wall, minimum 150mm thickness, density 650 kgm ³ or greater	287810B Issue 2	24/07/13	E120 (VE I ↔ O) S

2550 IN 2 HOUR FLOOR – RIGID CONSTRUCTION WITH HEVAC FRAME					
Size	Installation method	Supporting construction	Report no.	Date	Performance classification
Up to 1,000 x 1,000mm Single section	HEVAC	Concrete floor, minimum 150mm thickness, density 650 kgm ³ or greater	287810C	24/07/13	E120 (HO I ↔ O) S

2500 SERIES FIRE SMOKE CONTROL DAMPER Declaration of Performance (DoP)

Complying with EU Regulation: 305/2011/EEC Construction Products Regulation



AFS – 2 HOUR WALL

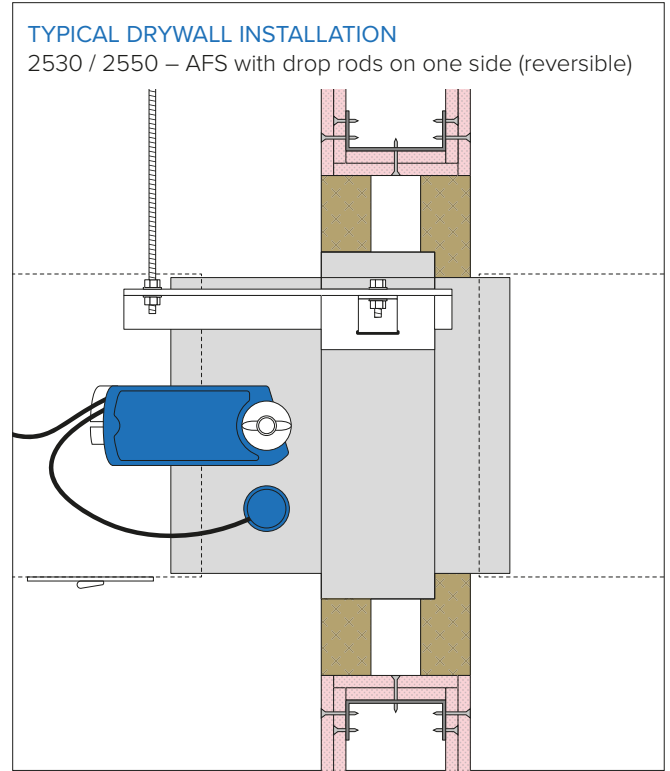
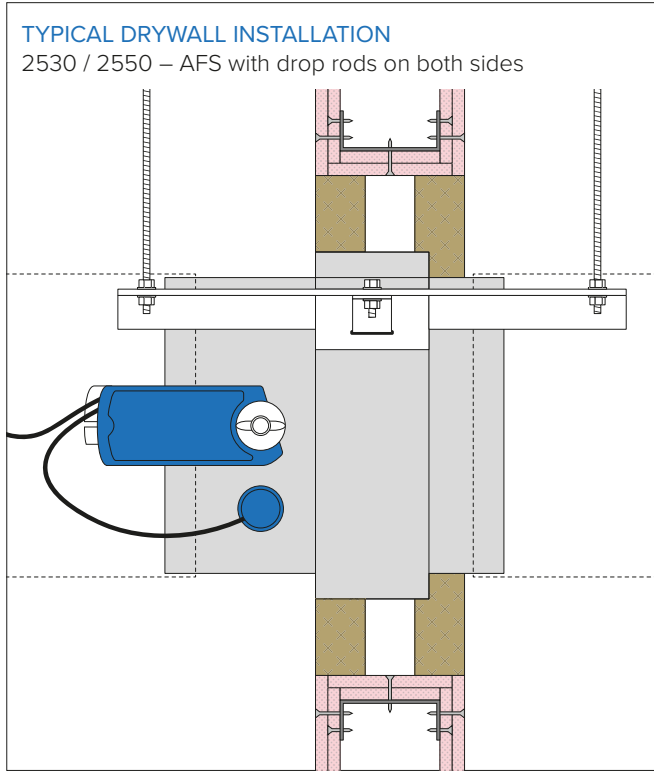

2530 / 2550 IN 2 HOUR WALL – FLEXIBLE OR RIGID CONSTRUCTION WITH AFS BRACKETS, SUPPORT ON BOTH SIDES					
Size	Installation method	Supporting construction	Report no.	Date	Performance classification
Up to 1,000 x 1,000mm Single section	AFS adjustable frame	Flexible wall, Types A, B & C, minimum 122mm thick Rigid wall, minimum 122mm thickness, density 650kg/m ³ or greater	EFR-21-001847	29/07/21	E120 (VE I ↔ O) S

2530 / 2550 IN 2 HOUR WALL – FLEXIBLE OR RIGID CONSTRUCTION WITH AFS BRACKETS, SUPPORT ON ONE SIDE (REVERSIBLE)					
Size	Installation method	Supporting construction	Report no.	Date	Performance classification
Up to 1,000 x 1,000mm Single section	AFS adjustable frame	Flexible wall, Types A, B & C, minimum 122mm thick Rigid wall, minimum 122mm thickness, density 650kg/m ³ or greater	EFR-21-001847	29/07/21	E120 (VE I ↔ O) S

2500 SERIES FIRE SMOKE CONTROL DAMPER Declaration of Performance (DoP)

Complying with EU Regulation: 305/2011/EEC Construction Products Regulation



AFS – 1 HOUR WALL

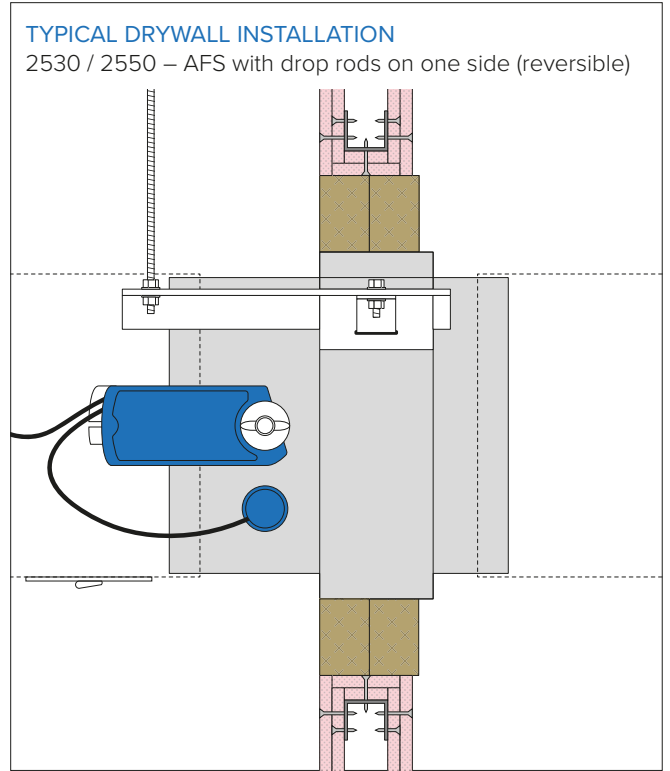
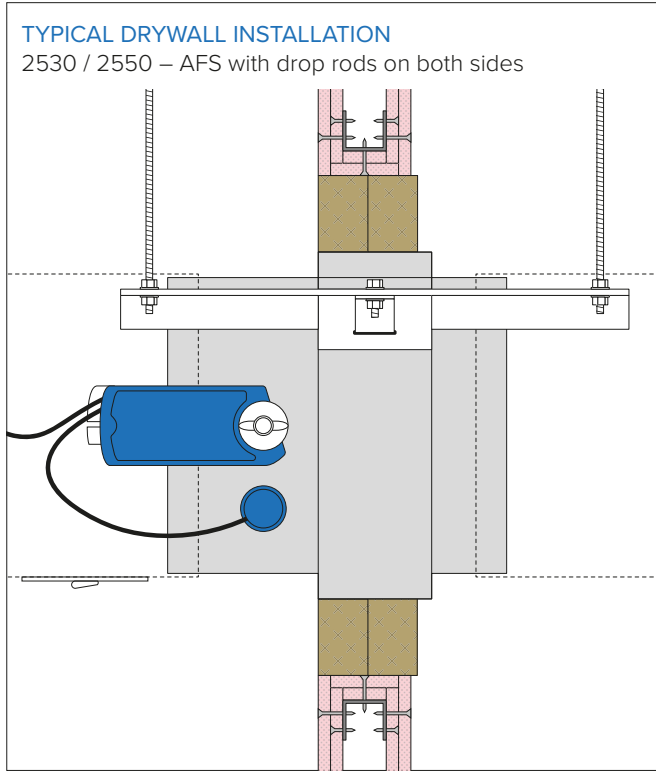

2530 / 2550 IN 1 HOUR WALL – FLEXIBLE OR RIGID CONSTRUCTION WITH AFS BRACKETS, SUPPORT ON BOTH SIDES					
Size	Installation method	Supporting construction	Report no.	Date	Performance classification
Up to 1,000 x 1,000mm Single section	AFS adjustable frame	Flexible wall Type A, B & C, minimum 94mm thickness; or Rigid wall, minimum 94mm thick with a density of 650 kgm ³ or greater	EFR-21-001847	29/07/21	E90 (VE I ↔ O) S

2530 / 2550 IN 1 HOUR WALL – FLEXIBLE OR RIGID CONSTRUCTION WITH AFS BRACKETS, SUPPORT ON ONE SIDE (REVERSIBLE)					
Size	Installation method	Supporting construction	Report no.	Date	Performance classification
Up to 1,000 x 1,000mm Single section	AFS adjustable frame	Flexible wall Type A, B & C, minimum 94mm thickness; or Rigid wall, minimum 94mm thick with a density of 650 kgm ³ or greater	EFR-21-001847	29/07/21	E90 (VE I ↔ O) S

2500 SERIES FIRE SMOKE CONTROL DAMPER Declaration of Performance (DoP)

Complying with EU Regulation: 305/2011/EEC Construction Products Regulation



AFS – 2 HOUR AWAY FROM WALL

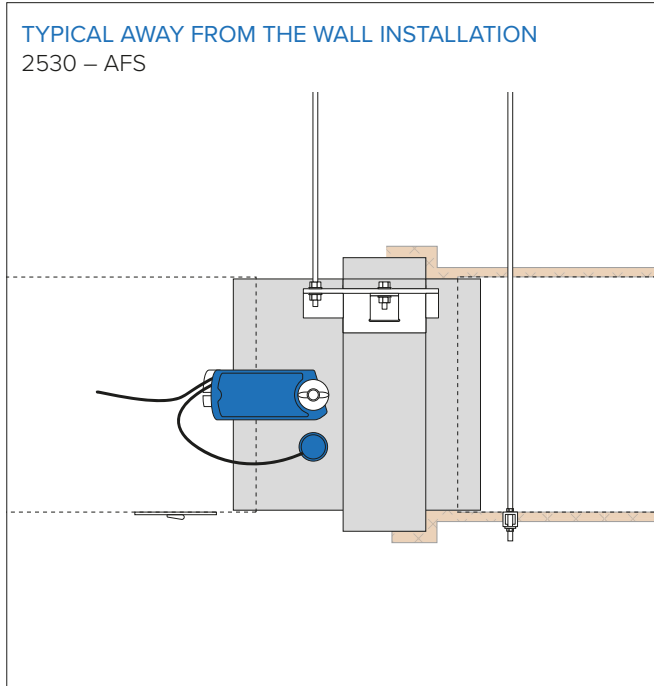

AFS – 2 HOUR FLOOR

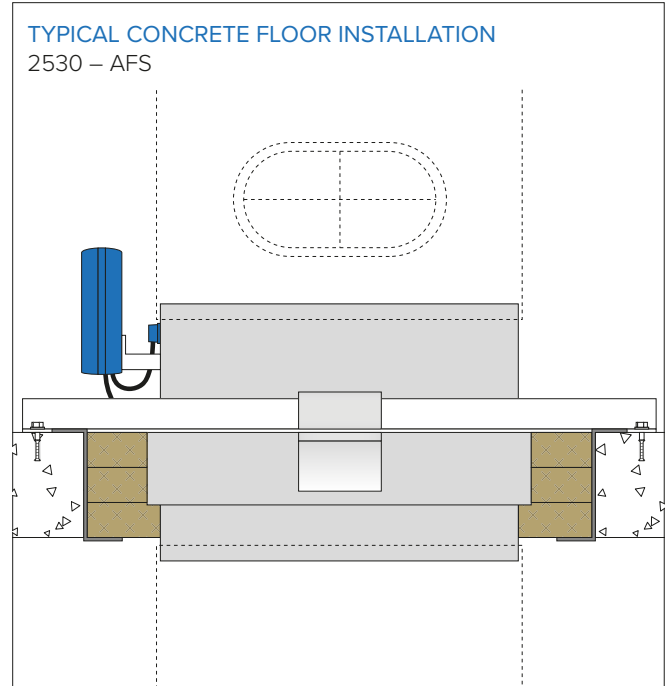

2530 IN 2 HOUR WALL – FLEXIBLE OR RIGID CONSTRUCTION, IN-LINE DUCT / AWAY FROM WALL					
Size	Installation method	Supporting construction	Report no.	Date	Performance classification
Up to 1,000 x 1,000mm Single section	Unistrut and drop rods	Flexible wall, Types B & C, minimum 131mm thick Rigid wall, minimum 131mm thick, density 650 kgm ³ or greater	2021-Efectis-R000927	01/06/21	E30 (VE I → O) S E120 (VE I → O)

2530 IN 2 HOUR FLOOR – RIGID CONSTRUCTION WITH AFS BRACKETS					
Size	Installation method	Supporting construction	Report no.	Date	Performance classification
Up to 1,000 x 1,000mm Single section	AFS adjustable frame	Concrete floor, minimum 150mm thick, density 650 kgm ³ or greater	EFR-21-001847	29/07/21	E120 (HO I ← O) S

2500 SERIES FIRE SMOKE CONTROL DAMPER Declaration of Performance (DoP)

Complying with EU Regulation: 305/2011/EEC Construction Products Regulation



MULTIPLE SECTION AFS – 2 HOUR WALL

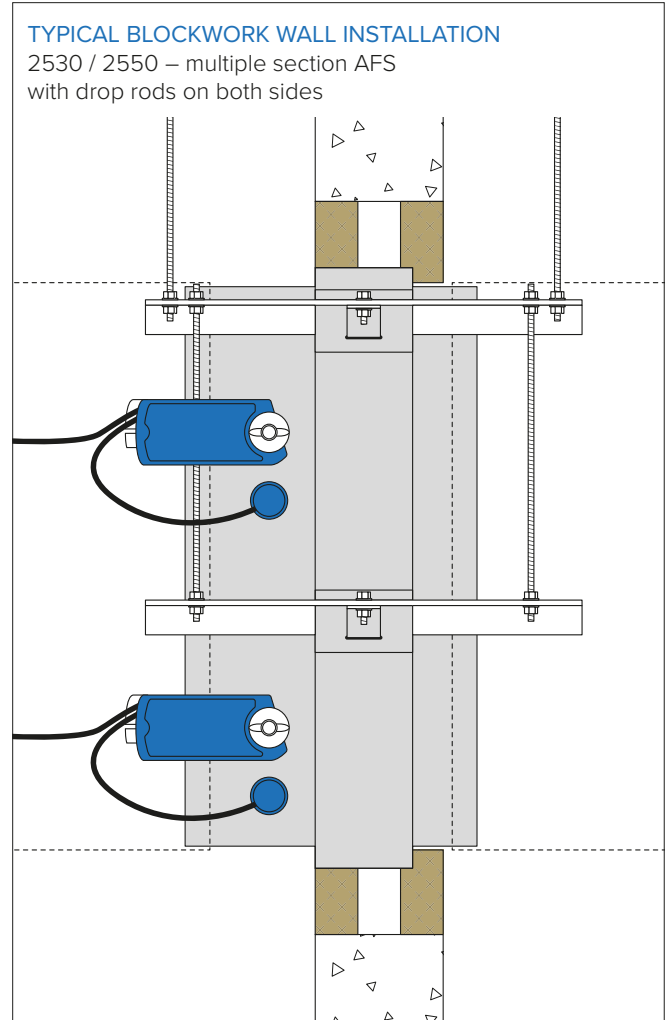
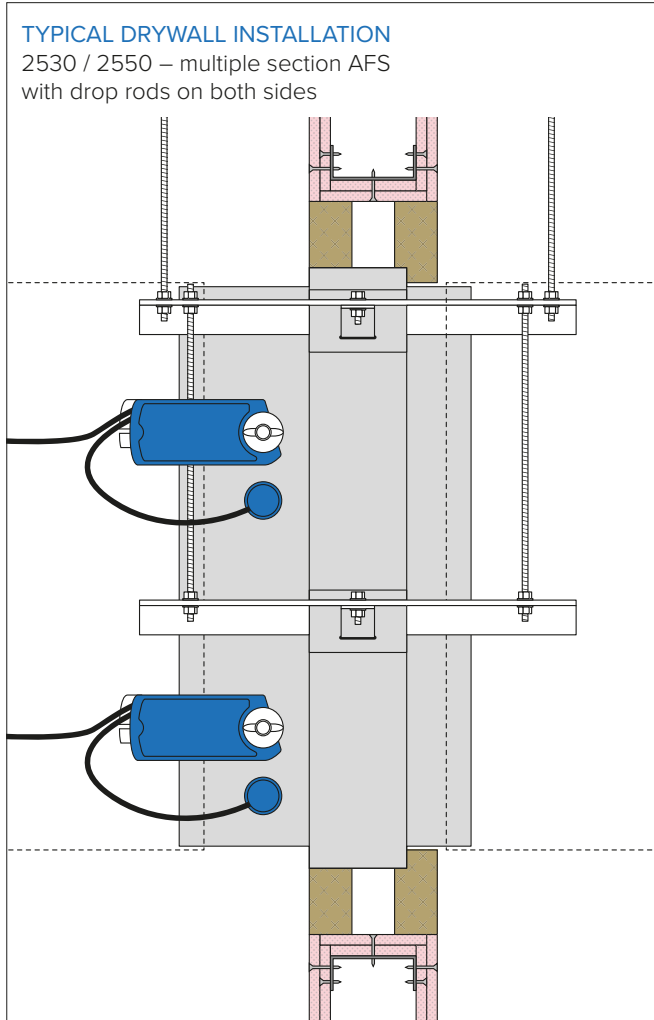

2530 / 2550 MULTISECTION IN 2 HOUR WALL – FLEXIBLE CONSTRUCTION WITH AFS BRACKETS, SUPPORT ON BOTH SIDES

Size	Installation method	Supporting construction	Report no.	Date	Performance classification
Up to 2,000 x 2,000mm Multiple section	AFS adjustable frame	2 hour wall Type C Minimum 150mm thickness	BRE287810A	06/02/20	E120 (VE I ↔ O) S

2530 / 2550 MULTISECTION IN 2 HOUR WALL – RIGID CONSTRUCTION WITH AFS BRACKETS, SUPPORT ON BOTH SIDES

Size	Installation method	Supporting construction	Report no.	Date	Performance classification
Up to 2,000 x 2,000mm Multiple section	AFS adjustable frame	Concrete wall, minimum 150mm thickness, density 650 kgm ³ or greater	BRE287810A	06/02/20	E120 (VE I ↔ O) S

2500 SERIES FIRE SMOKE CONTROL DAMPER Declaration of Performance (DoP)

Complying with EU Regulation: 305/2011/EEC Construction Products Regulation



BRITISH GYPSUM SHAFTWALL – 2 HOUR

CORRUGATED CONCRETE FLOOR – 2 HOUR

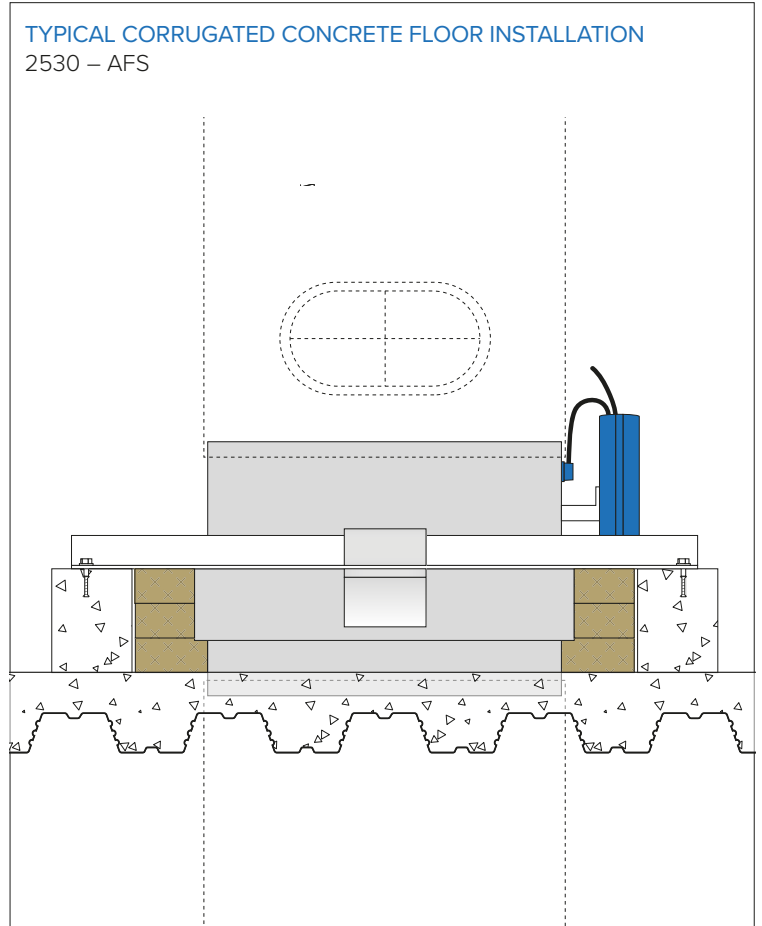
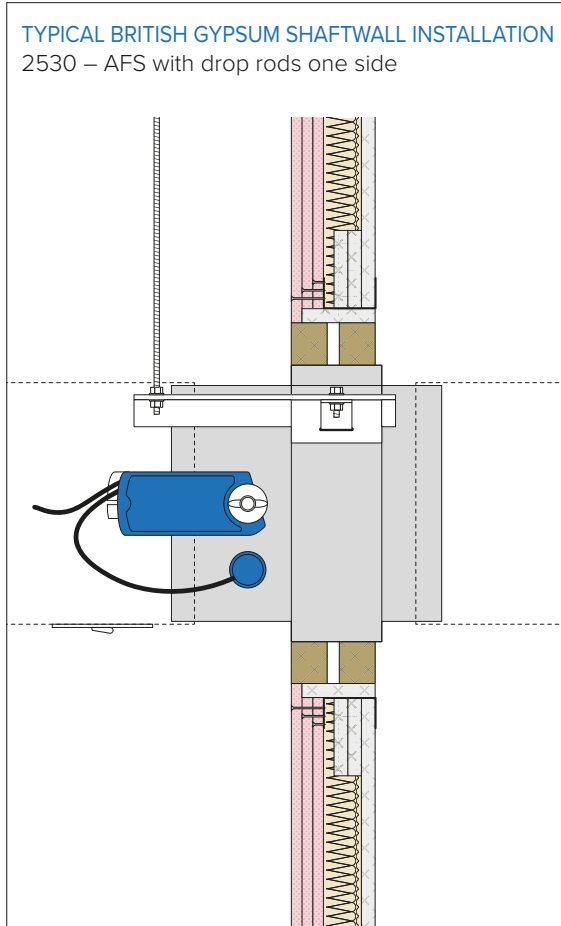

2530 IN 2 HOUR WALL – BRITISH GYPSUM SHAFTWALL WITH AFS BRACKETS SUPPORT ON ONE SIDE					
Size	Installation method	Supporting construction	Report no.	Date	Performance classification
Up to 1,000 x 1,000mm Single section	AFS adjustable frame	Flexible 2 hour British Gypsum shaftwall Minimum 107mm-thickness	EFR-21-001847	16/11/23	E120 (VE I ↔ O) S

2530 IN 2 HOUR FLOOR SLAB – CORRUGATED STEEL REINFORCED SLAB WITH CONCRETE UPSTAND WITH AFS BRACKETS SUPPORT RAILS ALONG OPENING					
Size	Installation method	Supporting construction	Report no.	Date	Performance classification
Up to 1,000 x 1,000mm Single section	AFS adjustable frame floor	2 hour floor slab with steel reinforced base and concrete upstand	LBO-1756-K_24E	15/05/24	E120 (HO I ← O) S

2500 SERIES FIRE SMOKE CONTROL DAMPER Declaration of Performance (DoP)

Complying with EU Regulation: 305/2011/EEC Construction Products Regulation



TRIMOTERM – 2 HOUR WALL WITH DRYWALL FLANGE

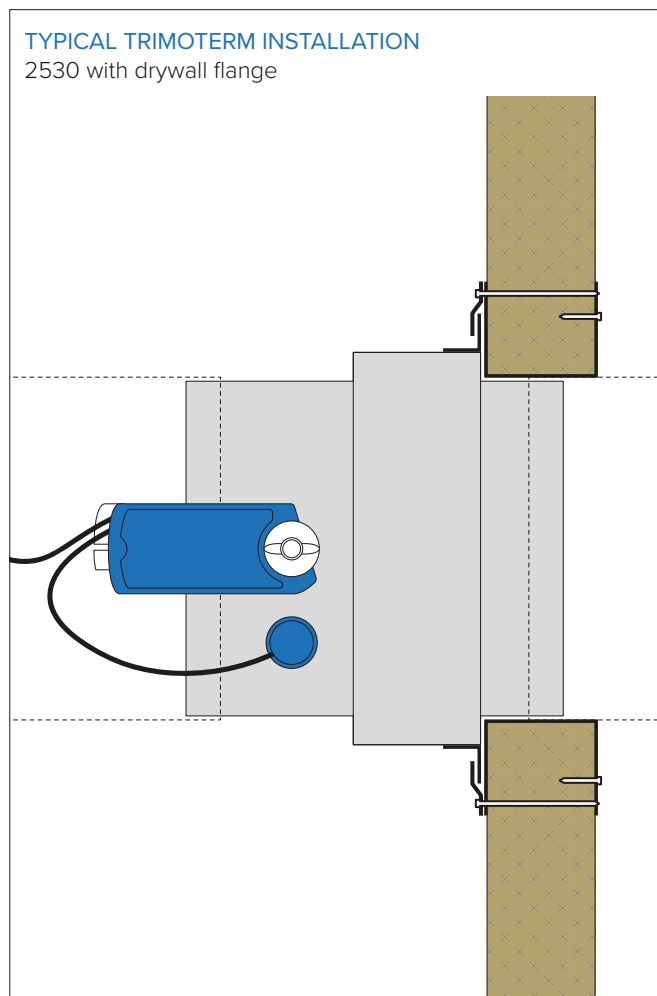

2530 IN 2 HOUR WALL – TRIMOTERM WITH DRYWALL FLANGE					
Size	Installation method	Supporting construction	Report no.	Date	Performance classification
Up to 1,000 x 1,000mm Single section	Flange and capping	Trimoterm FTV, Perform C / Power S Minimum 120mm thickness	2022-Efectis-R000301	01/03/22	E90 (VE I ↔ O) S E120 (VE I ↔ O)